

Oval Tubular Handles

Tube Aluminum, Handle Legs Plastic

SPECIFICATION

Handle tube

Aluminum

- Powder coated
Black, RAL 9005, textured finish **SW**
Handle legs / Covers, black, matte finish
- Anodized, natural color **ELS**
Handle legs / Covers, black, matte finish
- Anodized, natural color **ELG**
Handle legs / Covers, light gray, matte finish

Handle legs / Covers

Plastic, Polyamide (PA)

- Glass fiber reinforced
- Operating temperature up to 100 °C

Bushing

Steel, zinc plated



INFORMATION

Characteristic for the design of the GN 366 oval handles: Tube and handle leg are made in the same elliptical profile.

TECHNICAL INFORMATION

- Load Rating Information (see page A35)
- Plastic Characteristics (see page A2)

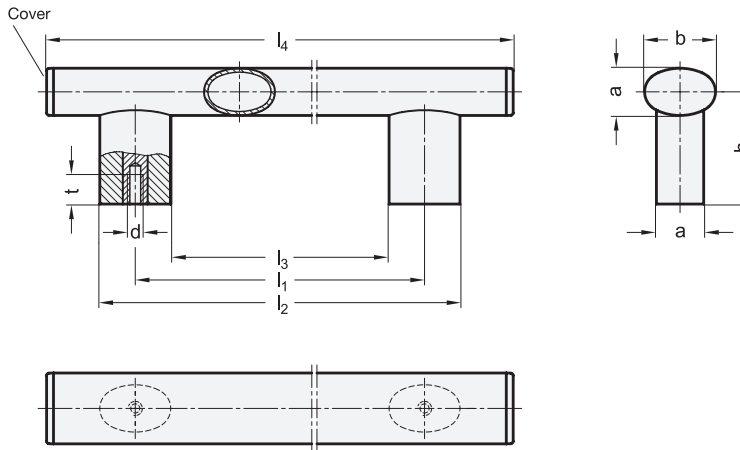

* Complete with



GN 366

Description	b	d	l1 ±0.5	a	h	l2	l3	l4	t min.	⚖
GN 366-36-M6-200-*	36	M 6	200	24	57	236	164	290	15	345
GN 366-36-M8-200-*	36	M 8	200	24	57	236	164	290	15	337
GN 366-36-M6-250-*	36	M 6	250	24	57	286	214	340	15	397
GN 366-36-M8-250-*	36	M 8	250	24	57	286	214	340	15	389
GN 366-36-M6-300-*	36	M 6	300	24	57	336	264	390	15	443
GN 366-36-M8-300-*	36	M 8	300	24	57	336	264	390	15	434
GN 366-36-M6-400-*	36	M 6	400	24	57	436	364	490	15	522
GN 366-36-M8-400-*	36	M 8	400	24	57	436	364	490	15	514
GN 366-36-M6-500-*	36	M 6	500	24	57	536	464	590	15	610
GN 366-36-M8-500-*	36	M 8	500	24	57	536	464	590	15	602
GN 366-36-M6-600-*	36	M 6	600	24	57	636	564	690	15	693
GN 366-36-M8-600-*	36	M 8	600	24	57	636	564	690	15	685

Weight SW